

CURA retrofitting for E-Bike

Service Manual –

This manual contains informations regarding the CURA standard brake retrofitting for E-Bike.





Index

Important informations	3
Parts list	3
Exploded view	4
Required tools	5
Upgrade CURA E-Bike	5

Important informations

IMPORTANTE	
	Repeatedly using our products in extreme conditions requires more frequent servicing. Using unrecommended high-pressure washing methods, using unrecommended spare parts, solvents and lubricants not recommended by Formula reduce the life span of our products.

IMPORTANTE	
	<ul style="list-style-type: none">Formula recommends only ORIGINAL spare parts and lubricant products.Formula recommends consulting servicing technicians for these activities.

INFORMAZIONI DI SICUREZZA	
	Always wear nitrile gloves and safety glasses when working on the shock absorber. Ensure correct disposal of waste materials and liquids.

Parts list

Part number	Description	Position
FD40292-20	KIT UPGRADE CURA EBIKE (HIGO)	1, 2, 3, 4, 5

Exploded view



Required tools

- Torque wrench with 3 mm tool.
- Allen key 3 mm
- Torx T10 key
- Formula mineral oil

Upgrade CURA E-Bike

Procedure

Remove the oil inside the brake system using the bleeding screw on the master cylinder and on the caliper, using a Torx T10 key. Dispose the oil correctly.

1. Remove the bleeding screw in the middle bleeding hole (6) on the master cylinder with a Torx T10 key.

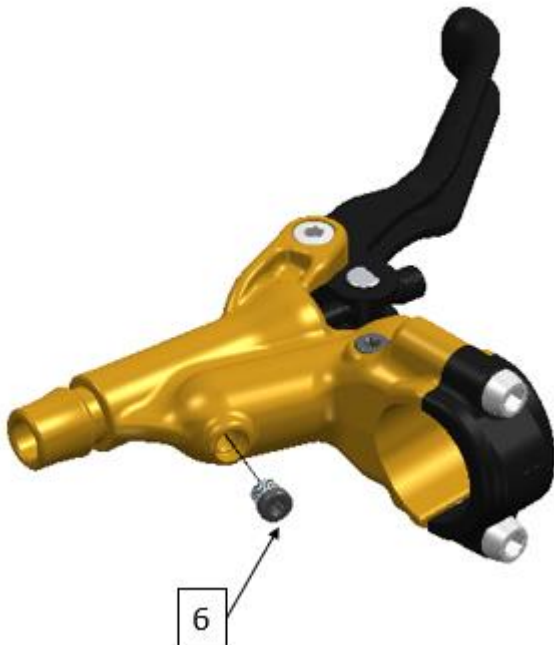

2. Place the O-Ring (1) in its seat on the bleeding screw included in the kit (2). Tight the knob (3) until the end of its stroke.



3. Tight the bleeding screw assembled in step 2 in the middle bleeding hole on the master cylinder. Use a torque wrench with 3 mm tool and a torque of 1.25 Nm.



4. Unscrew the lever pivot (7 and 8). Remove the dust seal (9) and the seeger (10), so that the lever and the pushrod can be removed.

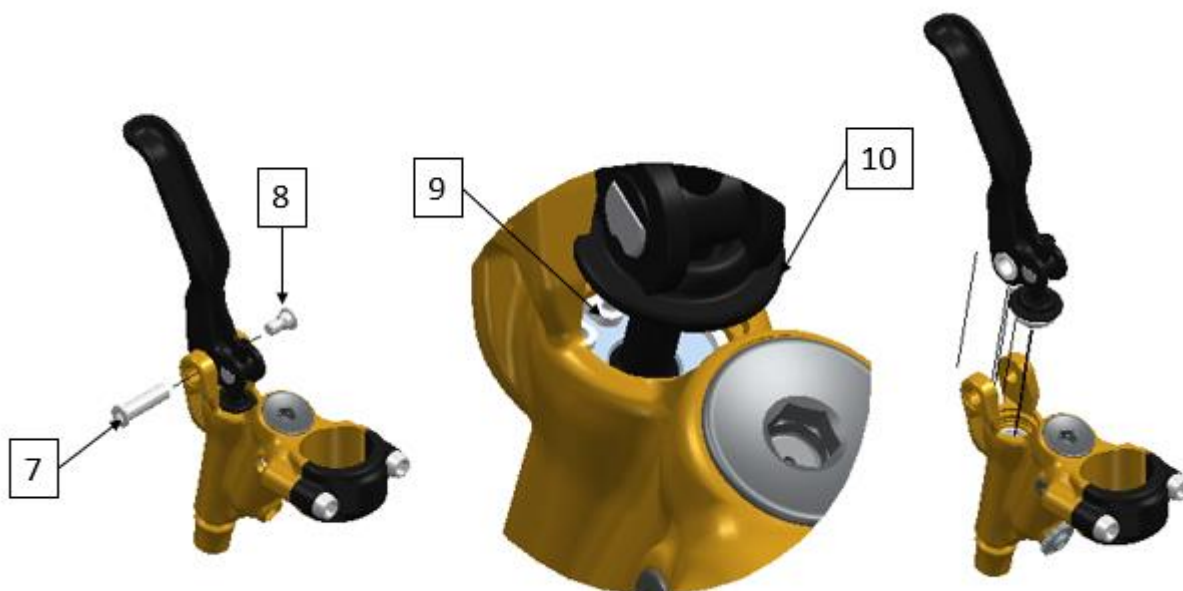

5. Place the magnet (5) in its seat on the piston(11) without removing it from its seat. Place back the lever, inserting the seeger and the dust seal back. To put the dust seal back use a not sharpened tool, in order to not damage the dust seal itself. Tight the lever pivot using a torque wrench with 3 mm tool (3 Nm) and a 3 mm allen key.



6. Place the reed sensor (4) until it fits well.



7. Bleed the brake with Formula mineral oil. For the correct procedure, follows the video on Formula's YouTube Channel: [Bleeding CURA](#).

<https://www.rideformula.com/it/>

FORMULA S.r.l.

Via Erbosa, 63 - 59100 Prato (Italia)

Tel. +39 0574 603 609

Fax +39 0574 611 046

Reg. Imprese Prato / C.F. / P.IVA 02081070977

PEC: formula-italy@legalmail.it

Cap. Soc. 500.000,00 € i.v.

The content of this document can be altered without notice. All rights reserved.

Revision 1 – January 2024